



**SHOPPING
GUIDE**

**FARMHOUSE
FACELIFT**

**JOHN &
KRISTINE**



- 1 LANDSCAPING:** *TMJ Outdoor Services*
- 2 PAVER STONES:** *Unilock* • style: Brussels Block • finish: Limestone
- 3 GARAGE DOOR:** *CHI Overhead Doors* • style: Stamped Carriage House • finish: White
- 4 GARAGE DOOR INSTALLATION:** *Brant Overhead Door*
- 5 SCONCES:** *Savoy House Lighting* • style: Ellijay 9" Steel Wall Lantern • finish: Black
- 6 BBQ:** *Broil King* • style: Regal S590 Pro
- 7 DOORS:** *Trimlite* • style: DRS29
- 8 DOOR HARDWARE:** *EMTEK* • style: Baden Entryset • finish: Flat Black



- 9 PILLOWS:** *Jaipur Living* • style: Burbank
- 10 LANTERN:** *Savoy House Lighting* • style: Ellijay 9" Steel Hanging Lantern • finish: Black

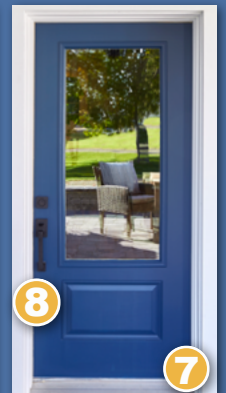



- 1 SEMI-FLUSH LIGHT:** *Kichler Lighting* • style: Cobson 16" Pendant • finish: Olde Bronze
- 2 SHIPLAP:** *Armstrong Ceilings* • style: Woodhaven #1148 • finish: Painted White
- 3 CABINetry:** *Wingers Cabinets*
- 4 CUSTOM CHALKBOARD:** *Architectural School Products*
- 5 FABRIC:** *Thibaut* • style: F972592 / F910083 / W80786
- 6 TILE:** *Ciot* • style: Brick Bristol Red / Treverkcharme Brown Natural
- 7 DOORS:** *Trimlite* • style: Two Panel Shaker #8402

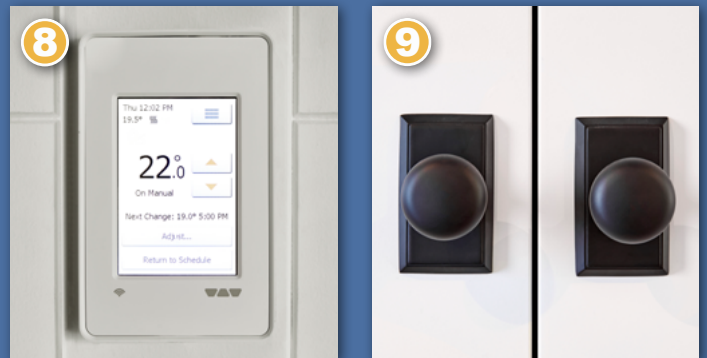

- 8 IN-FLOOR HEATING:** *Schluter-DITRA-HEAT*
- 9 HARDWARE:** *EMTEK* • style: Sandcast Bronze Rail Pull • finish: Flat Black / style: Providence Knob with Rectangular Rosette • finish: Flat Black
- 10 DOOR:** *Trimlite* • style: DRS29



- 1 WASHER & DRYER:** Electrolux • style: Front Load Perfect Steam Washer & Front Load Perfect Steam Electric Dryer • finish: Island White
- 2 CABINETRY:** Wingers Cabinets
- 3 HARDWARE:** EMTEK • style: Sandcast Bronze Rail Pull • finish: Flat Black / Sandcast Bronze Rustic Modern Round Knob • finish: Flat Black
- 4 COUNTERTOP & BACKSPLASH:** Premium Natural Quartz from MSI • style: Calacatta Clara
- 5 FAUCET:** Blanco Canada • style: BLANCO CULINA Mini • finish: Classic Steel
- 6 SINK:** Blanco Canada • style: QUATRUS R15 LAUNDRY • finish: Stainless Steel

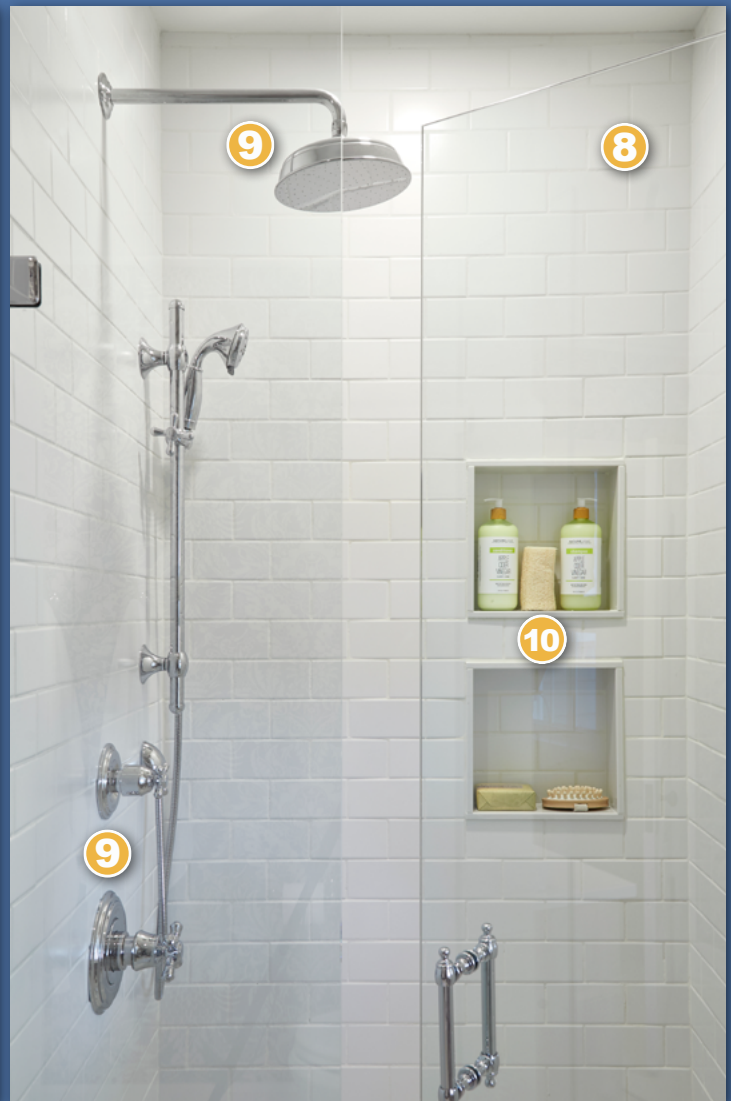

- 1 SHIPLAP:** *Armstrong Ceilings* • style: Woodhaven #1148 • finish: Painted White
- 2 SCONCE:** *Savoy House Lighting* • style: Monroe Sconce • finish: Polished Nickel
- 3 FAUCET:** *Delta Faucet* • style: Cassidy Two Handle Wall Mount Faucet • finish: Chrome
- 4 COUNTERTOP & BACKSPLASH:** *Premium Natural Quartz from MSI* • style: Calacatta Clara
- 5 VANITY/DRESSER:** *Paris Road Antiques*
- 6 KNOBS:** *EMTEK* • style: Old Town Clear Wardrobe Knob • finish: Chrome
- 7 WALLPAPER:** *Thibaut* • pattern: Chardonnet Damask • colorway: Navy
- 8 TILE:** *Ciot* • style: 3"x6" Evolution Blanco
- 9 SHOWER:** *Delta Faucet* • style: Cassidy - Shower Head / Valve / Transfer Valve
- 10 WATERPROOFING:** *Schluter Systems* - Schluter-Kerdi Shower Kit / Shower Niche



- 1 CEILING:** *Armstrong Ceilings* • style: Woodhaven #1148 • finish: Painted White
- 2 LIGHTING:** *Savoy House Lighting* • style: Alden Pendant / Drake Sconce • finish: Black
- 3 CABINETRY:** *Wingers Cabinets*
- 4 COUNTERTOP:** *Premium Natural Quartz from MSI* • style: Calacatta Clara
- 5 FLOORING:** *Timeless Materials* • style: Reclaimed Skip-Dressed Brownboard
- 6 FLOOR FINISH:** *Osmo* • Polyx-Oil • finish: Matte
- 7 SINK & FAUCET:** *Franke Kitchen Systems* • style: 33" Farmhouse Sink • finish: Fireclay White / style: Farmhouse Bridge Faucet • finish: Chrome





1 HOOD VENT: *Faber* • style: Chloe • finish: Black Matte

2 BACKSPLASH: *MSI Surfaces* • style: Carrara White Subway Tile 3"x6"

3 POT FILLER: *Franke Kitchen Systems* • style: Farmhouse • finish: Chrome

4 COOKTOP, WALL OVEN & FRIDGE: *Frigidaire* • style: Gallery 30" Gas Cooktop, 30" Single Electric Wall Oven, Counter-Depth 4-Door French Door Refrigerator

5 CABINET PULLS: *EMTEK* • style: Sandcast Bronze Rail Pull • finish: Flat Black

6 COOKWARE: *Oneida* • style: Tri-Ply Hammered Copper Cookware

7 MICROWAVE: *Frigidaire* • style: Gallery Built-In Microwave

8 SMALL APPLIANCES: *Breville* • Oracle Touch Espresso Machine • finish: Stainless Steel / Super Q Blender • finish: Black Truffle / Toast Select Luxe • finish: Sea Salt

9 PANTRY JARS: *Anchor Hocking* • style: Heritage Hill Jar with Glass Lid

10 COUNTERTOP FABRICATION: *Casey's Creative Kitchens*



- 1 CHANDELIER:** *Generation Lighting* • style: Hartsville 6 Light Chandelier
- 2 FABRIC:** *Thibaut* • pattern: Saybrook Stripe • colorway: Indigo & Sterling
- 3 GALLERY WALL:** *Picturewall*
- 4 TABLE:** *Ruffsawn*
- 5 RUG:** *Jaipur Living* • style: Inspirit 9'x10'
- 6 WALL ART:** *Canvas Gallery*
- 7 FLOOR LAMP:** *Generation Lighting* • style: Caroline Floor Lamp



FEATURED SUPPLIERS



Design & Construction www.cwdesignandco.com



Countertop Fabrication www.caseyskitchens.com



Floor Protection www.ramboard.com



Landscaping www.tmjos.ca



Custom Cabinetry www.wingerscabinets.com



On-Site Storage www.bigsteelbox.com



SUPPLIERS

ANCHOR  HOCKING Kitchen Accessories www.anchorhocking.com

Armstrong
CEILINGS Ceiling & Wall Coverings www.armstrongceilings.com

BLANCO Sink & Faucet www.blanco.com

Breville Small Appliances www.breville.com

Broil King
Great Barbecues Every Time Gas Grill www.broilkingbbq.com

CANVAS Wall Art www.canvasgallery.ca

EMTEK Door & Cabinet Hardware www.emtek.com

FABER
AIR MATTERS Hood Vent www.faberonline.com

FRANKE Sink, Pot Filler & Faucet www.franke.com

SUPPLIERS

GENERATION
LIGHTING

Lighting

www.generationlighting.com



JAIPUR LIVING

Area Rugs & Decor

www.jaipurliving.com

KICHLER

Lighting

www.kichler.com

osmo[®]

Floor Finish

www.osmo.ca

Picturewall[®]

Gallery Wall

www.picturewall.com



Glassware

www.riedel.com



Dining Table

www.ruffsawn.ca



Lighting

www.savoyhouse.com



**Waterproofing & In-
Floor Heating**

www.schluter.ca

SUPPLIERS

THIBAUT

WALLPAPER FABRIC FURNITURE

Fabrics & Wallpaper**www.thibautdesign.com****TRIMLITE****Doors****www.trimlite.com****UNILOCK**

DESIGNED TO CONNECT.

Paver Stones**www.unilock.com**